

CONTAINER SUBSTATION

Safe | Reliable | Compact



GENERAL

There are basically three types of prefabricated substations:

1. Mobile standard container substation
2. Fixed type standard container substation
3. Non-standard switch-room or power control room

All three can be manufactured to customers' specifications equipped with 6.6kV to 40.5kV GIS or 6.6kV to 17.5kV AIS and ancillary equipment.

Tamco standard containers utilize standard size land or marine transportation containers to meet different applications.

QUALITY

- TAMCO operates a Quality System in line with ISO9001 and ISO14001
- In addition to in-house routine and QC test, all switchgear products are fully type tested and certified by CESI/KEMA.

The switchgear specialist

www.tamco.com.my

TAMCO

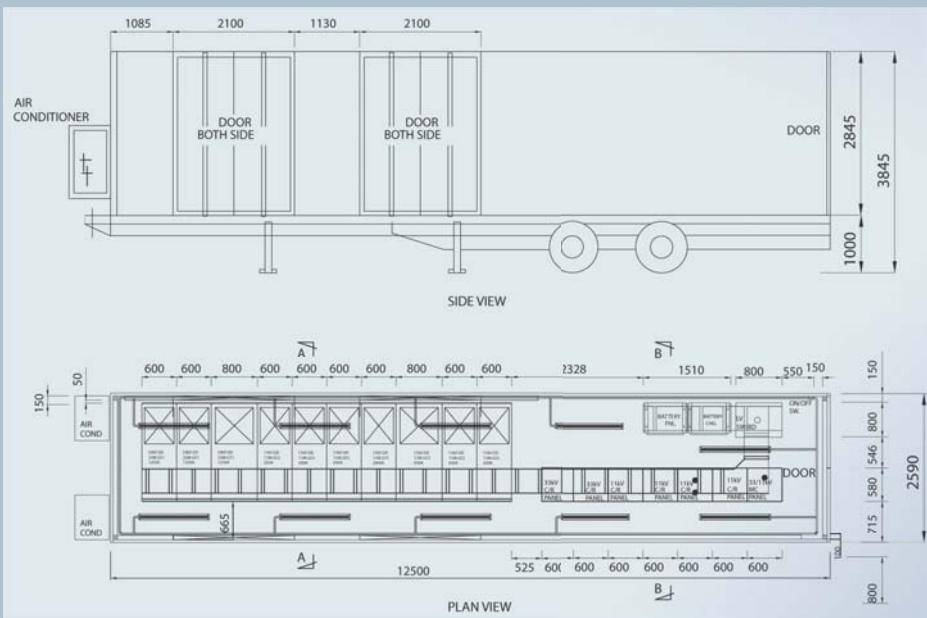

Compliance with

- IEC 62271-200 MV AIS & GIS
- IEC 62271-100 Vacuum Circuit Breaker
- IEC 62271-102 Disconnecter/Load Break/Earthing Switch

Ambient temperature range - 25°C to + 40°C

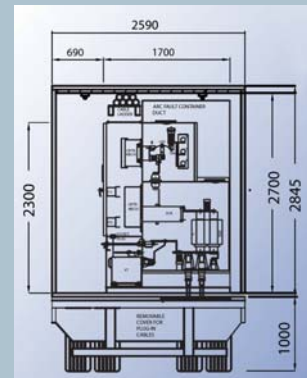

SECTION OF GIS MOBILE CONTAINER

Dimensions Of Standard Containers

DIMENSIONS	20 FOOTER	40 FOOTER
Length (mm)	9144	12192
Height (mm)	2896	2896
Depth (mm)	2600	2600
6.6 – 17.5kV AIS RATINGS		
Rated short circuit	25kA	31.5kA
Rated Current	1250A – 2000A – 2500A	1250A – 2000A – 2500A
6.6 – 40.5kV GIS RATINGS		
Rated short circuit	25kA	31.5kA
Rated Current	1250 – 2500A	1250 – 2500A

APPLICATIONS

- Temporary or permanent power supply solutions with minimum space
- Power supply for emergency situations
- Replacing power supply during major maintenance
- Seasonal increase in power demand
- Turn-key supply of standard container substations with minimum lead time and best quality
- Shortening site installation and commissioning time

STANDARD EQUIPMENT

- Battery and charger for DC control of LV and MV switchgear
- Normal air conditioning
- Wall mounted fire extinguishers are provided as standard
- Lightings and power sockets

KEY FEATURES

- Ready-to-use LV and MV substations
- Walk-in type containers with TAMCO compact and proven AIS & GIS
- Easy to transport using a standard container truck or a towing trailer
- Approved for transportation on land and sea
- Minimum levelling is required for the concrete base that supports the total weight
- Large cost saving since construction of substation is not required
- Customized LV and MV Switchgear layout for each type of application
- Fully assembled and tested in TAMCO factory
- All control and protection interfacing wiring are done in TAMCO
- SCADA system interfacing marshalling kiosks are available on request
- Control and relay panels or remote panels can be supplied
- Plug-in power cables and drawout VT are used for MV GIS

OPTIONAL OFFER

- Arc barriers or arc gas duct for MV AIS and GIS
- Container pressure relief flap
- Heating and Ventilation System (HVAC)
- Automatic smoke and heat detection alarm system and automatic shut down and gas suppression fire fighting system
- Shock proof spring loaded connection fluorescent lamps
- Switch-room structure designed to withstand severe seismic and cyclone conditions using computer simulation method
- Steel foundation base for fixed container or switch-room type substations
- Stainless Steel landing platforms



TAMCO Switchgear (Malaysia) Sdn Bhd

Sub Lot 24, Lot 16505, Jalan Keluli 1,
P.O.Box 2100, Kawasan Perindustrian Bukit Raja Seksyen 7,
40802 Shah Alam, Selangor Darul Ehsan, Malaysia.
Tel : +603-3361 8200
Fax : +603-3341 6200
Email : sales@tamco.com.my

Our Sales & Marketing Offices:

- Malaysia
- Indonesia
- KSA
- UAE
- Qatar
- Oman
- India

www.tamco.com.my